

Area of New Road

ENTERPRISE STREET
(26-57-58-59-60-61-62-63-35-64-65-66-67-68-27-26).... **1226 m²**
MICHELMORE STREET
(3-34-46-31-47-48-49-50-51-52-29-53-54-55-56-17-16-18-19-37-38-39-15-40-30-41-42-32-43-44-45-33-4-3).... **1.491 ha**

Total... 1.6136 ha

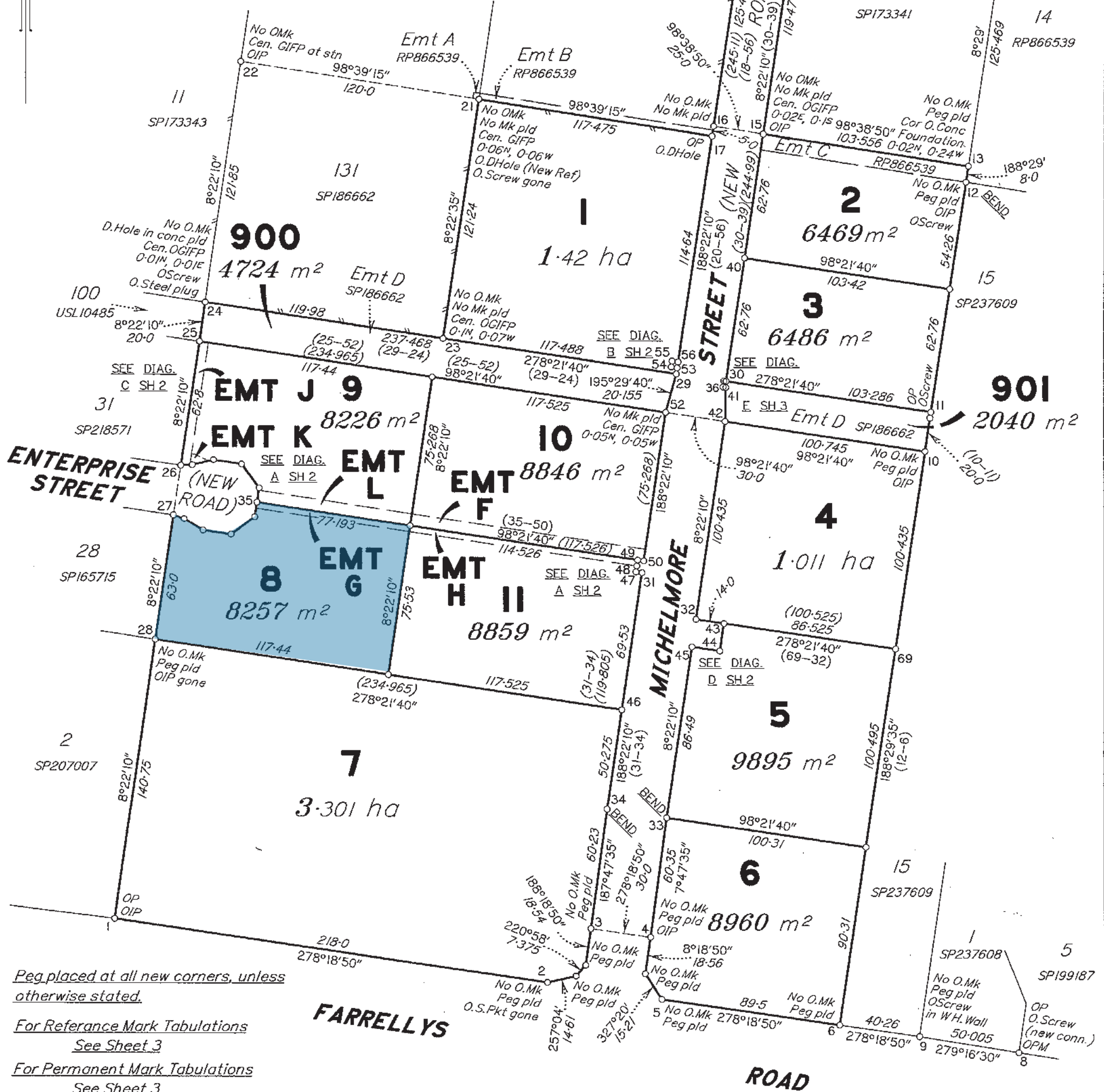

Peg placed at all new corners, unless otherwise stated.
For Reference Mark Tabulations See Sheet 3
For Permanent Mark Tabulations See Sheet 3

BRAZIER MOTTI PTY LTD (ACN 066 411 041) hereby certify that the land comprised in this plan was surveyed by the corporation, by Hayden Daniel BRUCE, Graduate Surveyor, for whose work the corporation accepts responsibility, under the supervision of Eric Arnold HANSEN, Cadastral Surveyor, and that the plan is accurate, that the said survey was performed in accordance with the Survey and Mapping Infrastructure Act 2003 and Surveyors Act 2003 and associated Regulations and Standards and that the said survey was completed on 29/05/2012.

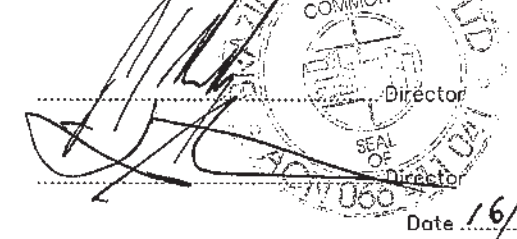

<p>0m 100m 200m 300m 50mm 100mm 150mm</p> <p>State copyright reserved.</p>	
<p>Plan of Lots 1 - 11 & 900 - 901, Easement J, K & L in Lot 9, Easement F in Lot 10, Easement G in Lot 8 & Easement H in Lot 11</p>	
<p>Scale: 1:2000</p>	
<p>Format: STANDARD</p>	
<p>SP244234</p>	
<p>Plan Status:</p>	
<p>PARISH: HOWARD</p>	<p>COUNTY: Carlisle</p>
<p>Meridian: MGA Zone 55 Vide SP235539</p>	<p>F/N's: No</p>

Date **16/8/12**