

SURVEY PLAN

PERMANENT MARKS

PM	ORIGIN	BEARING	DIST	NO	N&C
1-QPM	8/W30138	98°50'	2-015	48270	
11w-OPM	6/W30147	at station		78838	

Branded Peg placed at all subject lot corners
 Branded Stakes placed beside all new pegs

WARWICK INDUSTRIAL ESTATE

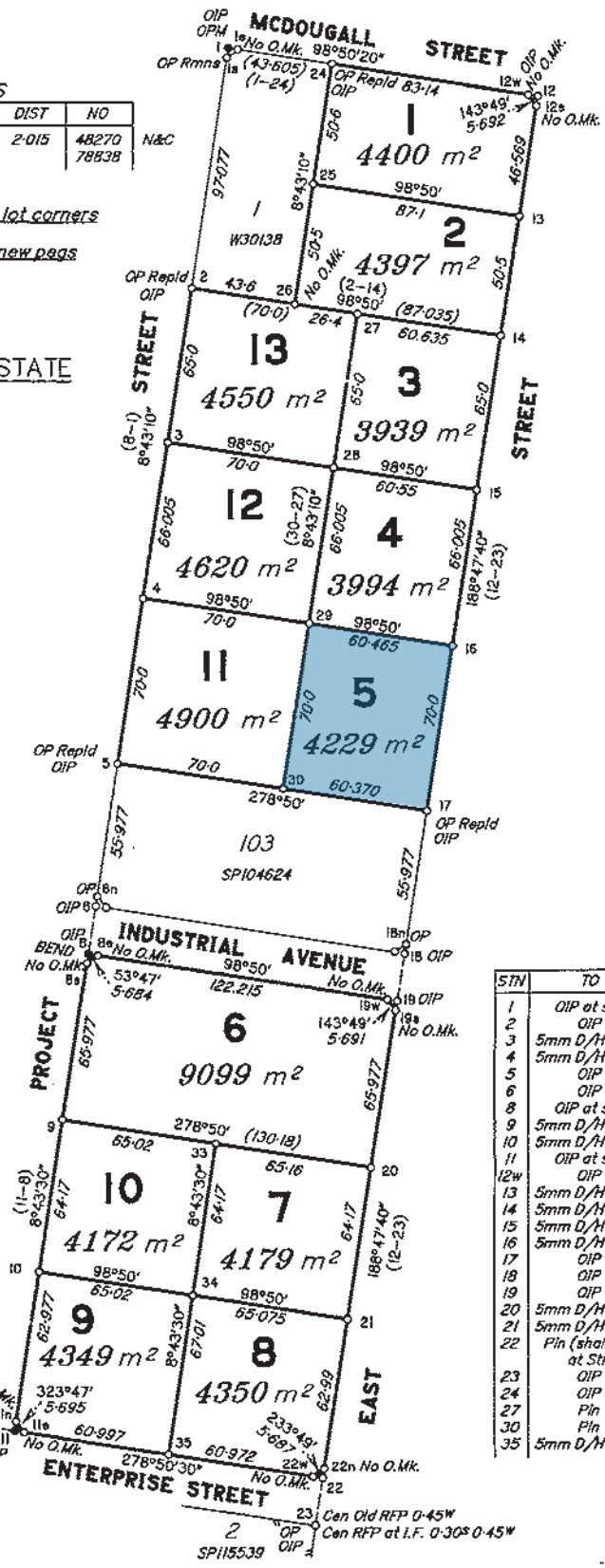
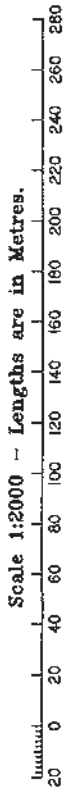

TRAVERSES ETC

LINE	BEARING	DISTANCE
1-1a	98°50'20"	4-023
1-1s	188°43'10"	4-023
6-6n	8°43'10"	4-023
6-8	188°43'10"	29-13
8-8a	98°50'	4-023
8-8s	188°43'30"	4-023
11-11a	98°50'30"	4-023
11-11n	8°43'30"	4-023
11-11w	278°50'40"	20-136
12-12s	188°47'40"	4-023
12-12w	278°50'20"	4-023
18-18n	8°47'40"	4-023
18-19	188°47'40"	20-13
19-19s	188°47'40"	4-023
19-19w	278°50'	4-023
22-22n	8°47'40"	4-023
22-22w	278°50'30"	4-023
22-23	188°47'40"	20-117

REFERENCE MARKS

STN	TO	ORIGIN	BEARING	DIST	N&C
1	OIP at stn	10/W30114			
2	OIP	6/W30138	280°	1-0	N&C
3	5mm D/H in Kb		278°53'	3-012	
4	5mm D/H in Kb		278°50'	2-952	
5	OIP	4/SP104624	278°39'	1-23	
6	OIP	3/SP104624	8°43'	2-89	
8	OIP at stn	20/W30114			0-6 deep
9	5mm D/H in Kb		278°50'	2-78	
10	5mm D/H in Kb		278°50'	2-803	
11	OIP at stn	25/W30114			
12w	OIP	11b/W30114	8°50'	1-005	
13	5mm D/H in Kb		98°50'	4-53	
14	5mm D/H in Kb		98°50'	4-566	
15	5mm D/H in Kb		98°50'	4-572	
16	5mm D/H in Kb		98°50'	4-65	
17	OIP	10/SP104624	98°50'	1-48	
18	OIP	16/W30114	98°50'	0-523	
19	OIP	21/W30114	98°50'	0-54	
20	5mm D/H in Kb		98°50'	4-89	
21	5mm D/H in Kb		98°50'	4-77	
22	Pin (shallow) at Stn				
23	OIP	3a/RP167461	98°51'	1-0	
24	OIP	3/W30138	8°43'	1-07	N&C
27	Pin		188°43'	3-012	
30	Pin		8°43'	3-056	
35	5mm D/H in Kb		188°43'30"	3-022	



I, David William MALLETT hereby certify that I have surveyed the land comprised in this plan personally, that the plan is accurate, that the said survey was performed in accordance with the Surveyors Act 1977 and the Surveyors Regulation 1992 and that the said survey was completed on 28 July 2001.

David Mallett
 Licensed Surveyor

Date: 3 August 2001

Plan of LOTS 1 - 13
 Cancelling Lot 99 on SPI04624 and
 Lot 102 on W30114

PARISH: **WARWICK** COUNTY: **MERIVALE**
 Meridian: **MGA** - derived from SPI15539 & SPI04624 - Zone 56 F/N's: **No**

Scale: **1:2000**
 Format: **STANDARD**

SP129493
 Plan Status: